



**Birchwood, Chineham, Basingstoke,
Hampshire, RG24 8TY**

Offer Over: £315,000

LODDON PROPERTIES introduce this idyllic three bedroom home, nestled in the tranquil Chineham neighbourhood. This charming property boasts a welcoming living room complemented by an open plan kitchen/dining over looking the rear garden. Stepping through patio doors, you'll find a delightful garden perfect for enjoying sunny days or hosting gatherings. Upstairs can be found three bedrooms, the master benefiting from over the stair storage and a modern bathroom with shower over bath. This residence also offers the added convenience of two allocated parking spaces.

Birchwood is situated in a quiet cul-de-sac within Chineham boasting local amenities, plenty of green areas, a shopping centre with retail outlets, doctors, dentist and highly recommended schools. The welcoming ambience of The Chineham Arms pub and Four Lanes infant and Junior school offers an ideal setting for family life. Basingstoke town centre is a short drive away with a wide range of retail and recreational facilities, bars and restaurants. With great commuter routes to the M3 & M4 and a mainline railway station with fast trains to London Waterloo (approx. 45 minutes) this property is an ideal starter/family home in a very sought after location.

TENURE: F

COUNCIL TAX BAND: C

EPC RATING: To Follow





- CLOSED CHAIN!
- THREE BEDROOM FAMILY HOME
- SPACIOUS LIVING ROOM
- WELL -PRESENTED THROUGHOUT
- OPEN PLAN KITCHEN/DINING ROOM
- MODERN BATHROOM
- BUILT IN STORAGE
- THREE ALLOCATED PARKING SPACES
- CUL-DE-SAC LOCATION



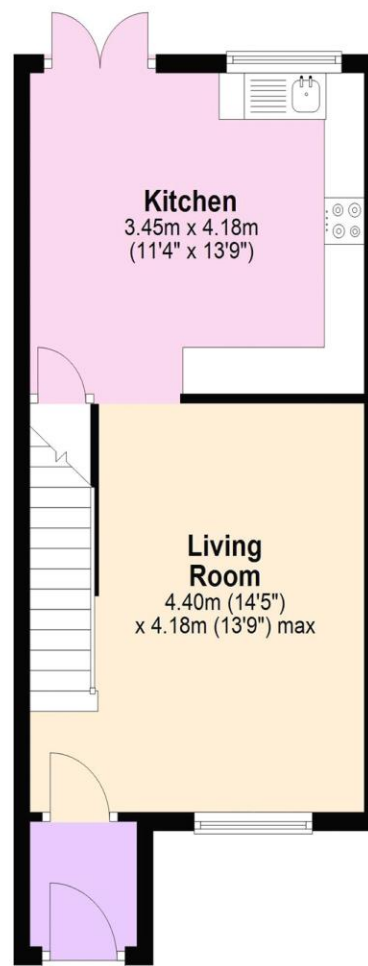

Ground Floor

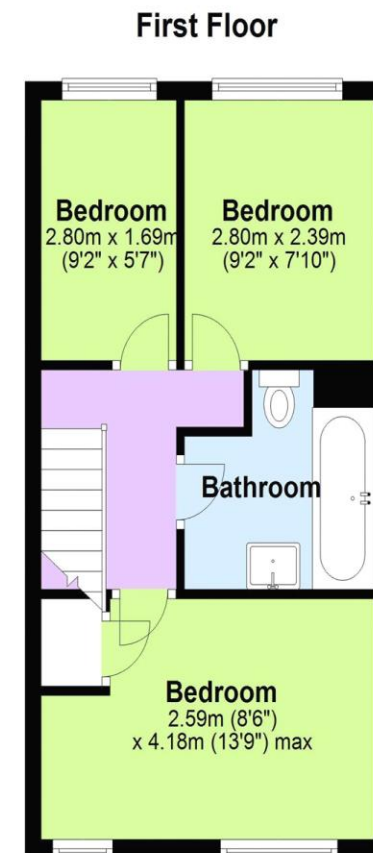

First Floor

All images used are for illustrative purposes only and are intended to convey the concept and vision for the property. They are provided as a guide only, and should be used as such. Floor plans are intended to give a general indication of the properties layout only. All images and dimensions are not intended to form part any contract or warranty.

Plan produced using PlanUp.

LODDON PROPERTIES

TEL: 01256 808 454

Chineham Shopping Centre Reading Road Chineham Basingstoke Hampshire
RG24 8BQ

info@loddonproperties.com

www.loddonproperties.com